

Cam switches

series
T|TB|TF|TP

Cam switches available in different construction models over a wide current range with a large variety of accessories.

According to:
IEC/EN 60947-3
UL508 - CAN/CSA C22.2 N° 14
RoHS

Testing and approvals:



Cam switches are manufactured in different series under strict quality controls to provide a reliable product that meets the most demanding requirements. They consist of chambers, each containing up to two double break contacts of positive opening. These contacts silver alloy plated providing a long electromechanical life.

In sizes 0 - 1 and 2, the terminals are equipped with captive clamp screws to facilitate installation work, and all the connections themselves are covered to provide an IP20 protection rating. The different configurations of contacts available provide flexible, faster and safer solutions for several electrical operations at a highly competitive cost.

Range coding:

Standard products

They are listed in this section and are encoded according to the 16-digit bar logic explained below. This descriptive method will be used on all pages in the cam switches range for your convenience and better understanding.

Special products

They are made according to customer specifications or to comply with a diagram or special scheme. In these cases, the code is formed by the corresponding series (T-TB-TF-TP), the amperage and an order number assigned to the scheme (see blank diagrams form on page 49).

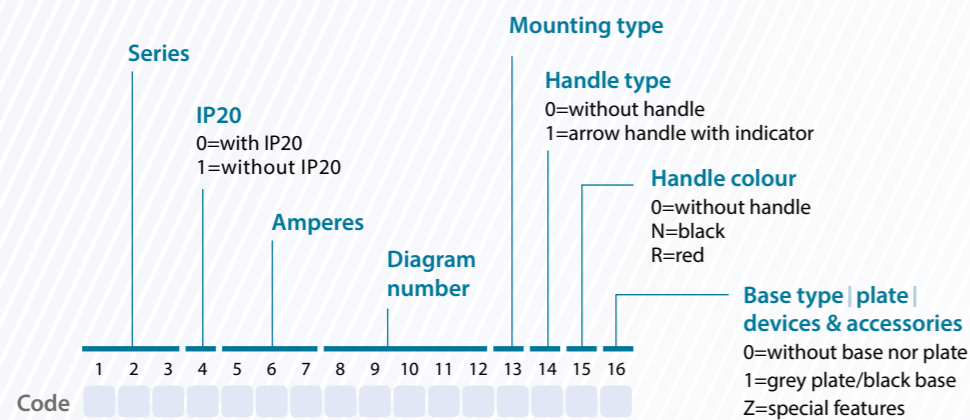

Example **T-0010000012E1N1**
T series | 100 amperes | 012 diagram | E fixing |
Standard handle | Black colour |
Grey plate/black base |

series **T**



Wide range of sizes and ratings.
Supplied with IP20 removable terminals protection on sizes 0 - 1 - 2 (except T175).
Wide range of devices and accessories.

series **TB**



Side access to all terminal screws (up and down).
Two different bodies depending on mounting type: door or base mounting.
Wide range of devices and accessories.

series **TF**



Square body, smooth sides, axial access to terminal screws.
Two different bodies depending on mounting type: door or base mounting.
Wide range of devices and accessories.

series **TP**



Reduce-sized body. Door mounting only.
Wide range of devices and accessories.

series | type **TIP**



- > Cam switch in plastic enclosure for gland entry.
- > From 12 up to 40 A.
- > Padlockable handle under request.

series | type **T-TF|R**



- > Cam switch in plastic enclosure for gland entry.
- > From 25 up to 100 A.
- > Padlockable handle under request.

series | type **T-TB|A-C**



- > Cam switch in metal enclosure of cast aluminium
- > From 12 up to 63 A.
- > In sheet steel enclosure
- > From 100 A upwards.
- > Gland entry.
- > Several enclosure sizes.
- > Padlockable handle under request.

series | type **T-TB|F-L**



- > Cam switch in metal enclosure of cast aluminium
- > with fuse holders, from 16 up to 63A.
- > In sheet steel enclosure
- > with fuse holders, from 100A upwards.
- > Gland entry.
- > Several enclosure sizes.
- > Fuses not included.
- > Padlockable handle under request.

>> Ask for more information about these applications with enclosure.

TP | T | TB | TF

Door mounting

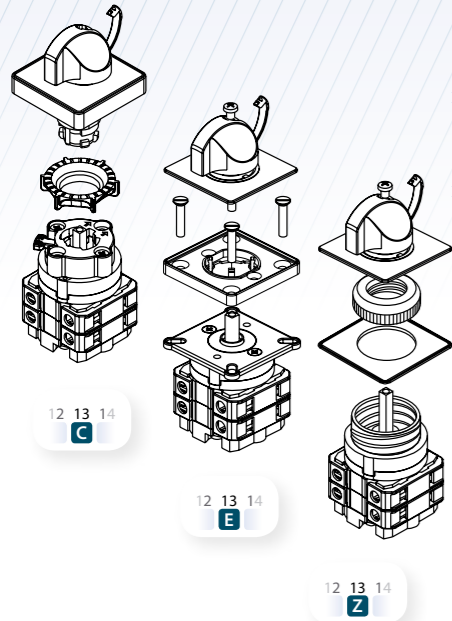

Fixing with screws | E type

For T - TB - TF - TP series

- > Frontal fixing plate for 4 screws, reversible mounting plate in T series (except T175 & size 3).
- > Door mounting with arrow handle, indicating plate, escutcheon and fixing plate IP65.

Central quick fixing $\varnothing 22$ | C type

For T - TB - TF series

- > Door mounting for $\varnothing 22$ mm available for sizes 0 and 1.
- > For arrow handle with indicator or padlockable handle.
- > Maximum number of chambers supported
Size 0 = 6
Size 1 = 4

Central fixing with metal nut $\varnothing 22$ | Z type

For T - TF series

- > Door mounting for metal nut $\varnothing 22$ mm available for sizes 0 and 1.
(also $\varnothing 30$ mm under request).

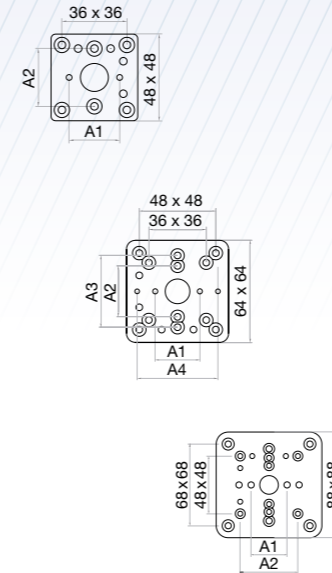

Size	Models		
0	A1 = 28 mm	A2 = 32 mm	M
	A1 = 30 mm	A2 = 34 mm	N
	A1 = 35 mm	A2 = 38 mm	O
1	A1 = 28 mm A4 = 46 mm	A2 = 32 mm	M
	A1 = 33 mm A3 = 47 mm	A2 = 30 mm A4 = 50 mm	N
	A1 = 32 mm A3 = 45 mm	A2 = 32 mm A4 = 45 mm	P
2	A1 = 38 mm	A3 = 40 mm	M
	A1 = 30 mm	A2 = 50 mm	P

Multi-distance fixing plates with screws

For T - TB - TF series

- > Multidrill plates for different fixing distances.
- > Fixing with two screws for mounting without base nor indicating plate.
- > Available for sizes 0 - 1 - 2.
(size 0 also supports multi-fixing plate size 1).

Base mounting

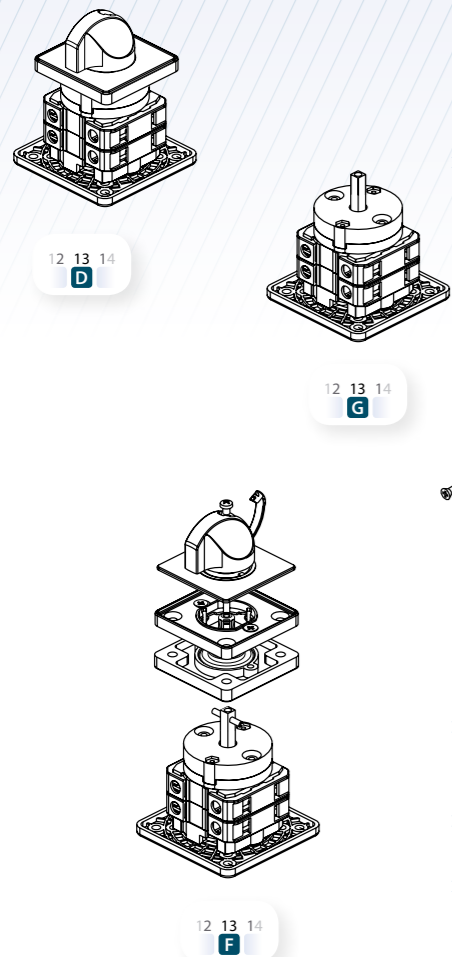

Base mounting by screws with direct handle | D type

For T series

- > Rear fixing plate for 4 screws, reversible mounting plate in T series (except T175 & size 3).

Base mounting by screws without plate and handle | G type

For TB - TF series

- > Fixed rear support plate as standard.
- > Serie TB for 4 screws.
- > Serie TF for two screws (also DIN rail).

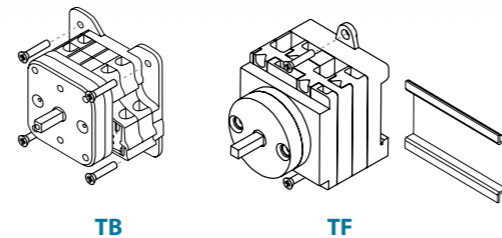
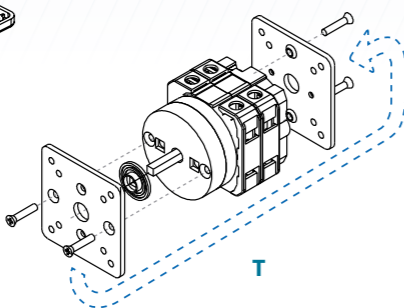

Base mounting with clutch device and door handle | F type

For T - TB - TF series

- > Rear fixing plate for 4 screws in T - TB series or two screws and DIN rail in TF series.
- > With clutch device and door lock, according to series and sizes.
- > The clutch device (D501) for size 0, if it is combined with other accessory, must be size 1.
- > The clutch device (D501) and shaft extension are supplied separately (as accessories) or incorporated with the cam switch (size 3 is always incorporated with the cam switch).
- > Specify useful depth of the space available when ordering.

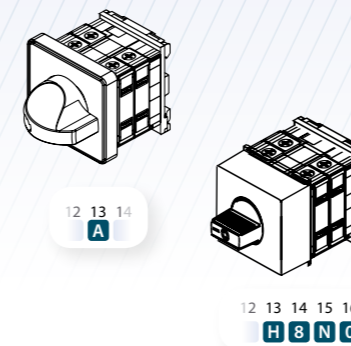

DIN rail mounting with direct handle | A type

For T series

- > Rear fixing support (D904) for T series sizes 0 and 1.
- > DIN rail is included in TF series.

DIN rail mounting with modular handle | H type

For TF series

- > Rear fixing support and modular handle tape (D905) for T - TF series size 0.

