

# S5000 AC Switch - disconnecter base mounting 3P - 3P+N

Size 3

A 800|1000|1250|2000

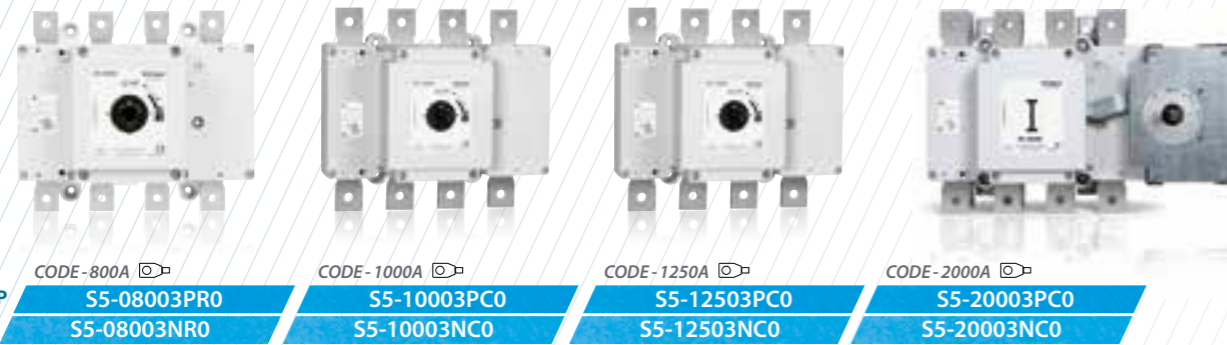

CODE-800A	CODE-1000A	CODE-1250A	CODE-2000A
3P S5-08003PRO S5-08003NR0	3P S5-10003PC0 S5-10003NC0	3P S5-12503PC0 S5-12503NC0	3P S5-20003PC0 S5-20003NC0

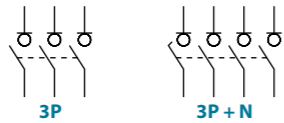

## Technical information



According to IEC/EN 60947-3

			800	1000	1250	2000	
Rated thermal current I <sub>th</sub> in ambient at	40 °C	A	800	1000	1250	2000	
	50 °C	A	800	1000	1125	1800	
	60 °C	A	800	900	900	1600	
Rated insulation voltage U <sub>i</sub>	V		1000	1000	1000	1000	
Rated dielectric strength	V	50 Hz, 1 min.	8000	8000	8000	8000	
Rated impulse withstand voltage U <sub>imp</sub>	kV		12	12	12	12	
AC rated operational current I <sub>e</sub> (Rated operational frequency 50/60 Hz)	U <sub>e</sub> 400V	AC21A	A	800	1000	1250	2000
	U <sub>e</sub> 400V	AC22A	A	800	1000	1250	2000 <sup>(*)</sup>
	U <sub>e</sub> 400V	AC23A	A	800	1000	1000	1400 <sup>(*)</sup>
	U <sub>e</sub> 500V	AC21A	A	800	1000	1250	2000
	U <sub>e</sub> 500V	AC22A	A	800	1000	1000	2000 <sup>(*)</sup>
AC rated operational power P <sub>e</sub>	3x400V	AC23A	kW	443,4	554,2	554,2	775,9
	Rated capacitor power	400V, sen φ = 0,65	kVAr	360,2	450,3	450,3	630,4
Rated breaking capacity	400V	AC23A	A	6400	8000	8000	11200
Rated making capacity	400V	AC23A	A	8000	10000	10000	14000

			800	1000	1250	2000
<b>Short - circuit behaviour</b>						
Rated short-circuit making capacity <sup>(*)</sup>	I <sub>cm</sub> kA (peak)		60	60	60	80
Rated short-time withstand current (1sec.)	I <sub>cw</sub> kA rms		25	25	25	38
Conditional short - circuit current (rms value) <sup>(*)</sup>	kA rms		72	72	72	-
Maximum cut - off current (peak value)	kA (peak)		55	55	55	-
Maximum power dissipation (I <sup>2</sup> t)	A <sup>2</sup> s (x10 <sup>3</sup> )		4900	4900	4900	-
<b>Mechanical features</b>						
Minimum number of mechanical operations <sup>(*)</sup>	Cycles		10000	10000	10000	10000
Maximum weight 3P	Kg		7	7	7	18,5
Maximum weight 3P+N	Kg		7,6	7,6	7,6	20

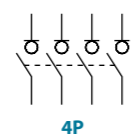

Also available 4P switches under request, consult reference

<sup>(\*)</sup> Other voltages and / or utilization categories. Please consult  
<sup>(\*)</sup> Indicative values: current values vary from one motor manufacturer to another  
<sup>(\*)</sup> Without limiting protective device (short-circuit maintained 50... 100 ms.)  
<sup>(\*)</sup> With a protective device limiting the cut - off current and the joule integral to the indicated values  
<sup>(\*)</sup> Please consult us for more operations  
<sup>(\*)</sup> Rated operational current AC22B



## Accessories



» Direct handle  
 CODE DS-LI31  
 CODE DS-LI41 (2000 A)



» External handle included shaft <sup>(\*)</sup>  
 IP65|UL50E/NEMA 250  
 Types: 1, 3R, 4, 4X y 12  
 CODE DS-LA31  
 CODE DS-LA41 (2000 A)



» External handle without shaft  
 IP65|UL50E/NEMA 250  
 Types: 1, 3R, 4, 4X y 12  
 CODE DS-LA33 (for 800-1000-1250A)



» Emergency external handle included shaft <sup>(\*)</sup>  
 IP65|UL50E/NEMA 250  
 Types: 1, 3R, 4, 4X y 12  
 CODE DS-LR31  
 CODE DS-LR41 (2000 A)

## » Shafts

Standard shaft included <sup>(*)</sup>		
L (mm)	P (mm)	
186	145... 242	
(2000 A)	239	145... 242

Shaft extensions		
Type 1		
L (mm)	P (mm)	CODE
345	145... 411	DS-EP23
(2000 A)	485	145... 244
Type 2		
L (mm)	P (mm)	CODE
535	145... 600	DS-EP24
(2000 A)	635	145... 600

## Dimensions (mm)

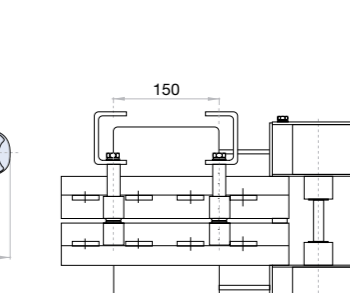
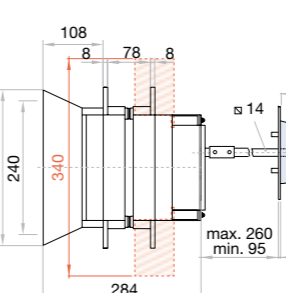
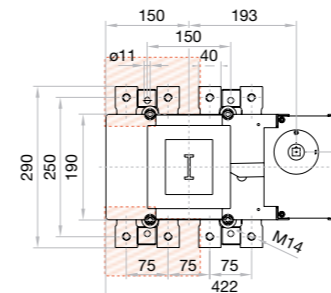
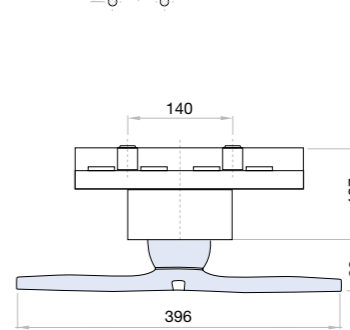
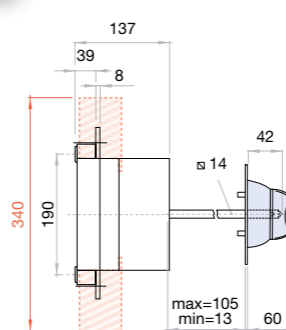
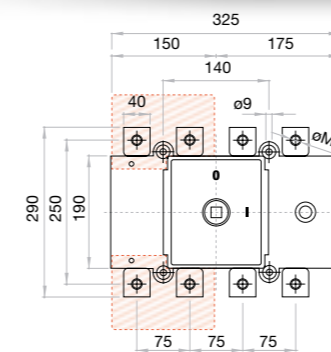

## Door drilling for external handle

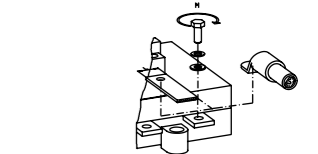
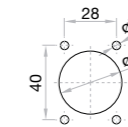
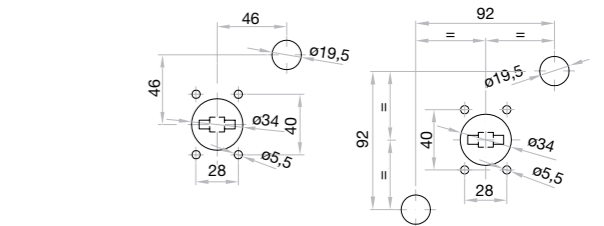

S max (Cu)	H max (Cu)	L max (Cu)	M
mm <sup>2</sup>	mm	mm	Nxm
800 A	2x240	2x10	50 M14 45
1000 A	2x300	2x10	50 M14 45
1250 A	2x300	2x10	50 M14 45

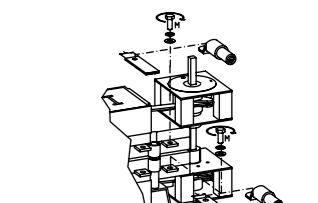

S max (Cu)	H max (Cu)	L max (Cu)	M
mm <sup>2</sup>	mm	mm	Nxm
2000 A	4x300	4x10	50 M14 45